



(ES) DO NOT COVER (CAT)
DO NOT CHARGE (PT) DO
NOT CHARGE (EN) DO NOT
COVER (IT) DO NOT COVER



HELSINKI CERAMIC WALL SPLIT

Please read the instructions carefully before first use and
maintenance

**THANK YOU FOR PLACING YOUR TRUST IN US AND CHOOSING OUR
CERAMIC WALL SPLIT!**



FULMO.

@FULMO_



WARNING!



Keep this product, small parts and plastics out of the reach of children. Inhalation of small parts or plastic may cause suffocation.



CAT Scan the QR code, find your product on the website and download the manual in Catalan.



PT Scan the QR code, find your product on the website and download the manual in Portuguese.

EN Scan the QR code, search for your product on the web and download the manual in English.

IT Scan the QR code, search for your product on the web and download the manual in Italian.

TABLE OF CONTENTS

1. SAFETY PRECAUTIONS	4
2. FEATURES	7
3. INSTALLATION	8
4. USE	10
5. DISPLAY	11
6. REMOTE CONTROL	12
7. OPEN WINDOW SYSTEM	14
8. WEEKLY TIMER	15
6. CLEANING AND MAINTENANCE	17
8. APPLIANCE RECYCLING	18
9. WARRANTY	19
10.ADDITIONAL INFORMATION	22

NAME: HELSINKI WALL-MOUNTED
CERAMIC SPLIT BRAND:
FULMO

MODEL: PTC-2020

AVANZZA TRADERS INTERNATIONAL S.L
C/ Marie Curie No. 20, 1st floor Andalusia
Technology Park 29590-MÁLAGA
www.avanzzatraders.com Tax ID: B42715680
info@avanzzatraders.com

**MADE IN
PRC**

1. R SAFETY PRECAUTIONS

Read all instructions before use. Keep this operating manual for future reference.

Do not leave the product unattended during use. Always supervise it in the presence of physically or mentally disabled persons, elderly persons, or animals. Always keep an eye on them when they are near the heater. Do not allow animals to touch or play with it. Do not allow animals or children under 10 years of age to touch the heater. If they are over 10 years of age, do not allow them to use it without supervision. Children should not play with the heater. Place the heater in places where they cannot reach it and warn them about the dangers of improper use of electrical appliances.

DO NOT COVER: Do not use the heater to dry clothes or hang anything on or in front of the heater. If covered, there is a risk of overheating. Do not move or relocate the appliance while it is in operation to avoid overheating. Plug it in and keep it on a flat, stable surface, without tilting.

Do not use it near a bath, shower or damp areas. Do not immerse it in water. Always use the heater in an upright position. Do not use the appliance in rooms smaller than 4 m² or that are not well insulated.



Do not use the heater if it is damaged or has been dropped. Place the heater 100 cm in front of and 50 cm away from combustible materials such as furniture, cushions, bedding, paper, clothing, curtains, etc. behind it. Do not use the heater in the presence of explosive or flammable substances. Never install it directly under a power outlet. Do not connect the heater and other high-powered electrical appliances to the same power outlet at the same time. Plug the appliance securely into the power outlet to prevent overheating and malfunction. Never pull on the cable to unplug the heater. Unplug the appliance once you have finished using it. If the cable of your appliance is damaged, do not use the heater.

The heater is equipped with a safety device that will switch it off if it accidentally overheats. To restart it, allow it to cool down first, unplug it from the power supply for a few minutes and then plug it back in. Once you have finished using it, ensure that the switch is in the off position and the thermostat is at the minimum setting. Always unplug the appliance after use. Keep the heater clean. Do not allow any objects to enter any ventilation or exhaust openings, as this may cause electric shocks, fires or damage to the heater. The heater is equipped with a safety device to prevent it from tipping over. If it is accidentally knocked over, the power will be cut off. When switched on for the first time, the heater may emit a slight odour for a few minutes.

This is harmless and occurs with most heaters when any slight traces of dust or lubricant that may have accumulated in the factory are removed by the heat.

Do not use the heater with any timer or programming device that turns it on automatically. The use of these devices is dangerous and may cause a fire hazard.

BATTERY PRECAUTIONS

The remote control uses a CR2025 button cell battery, which must be kept out of the reach of children, as swallowing it can cause serious internal burns, suffocation or even death. Children should not handle it without adult supervision. It is important not to short-circuit, heat, disassemble or throw the batteries into a fire.-vo under controlled and approved conditions. Always use the correct type and size of battery as recommended by the manufacturer. Keep this information for reference. Remove the battery if the equipment is not going to be used for a long period of time. Clean the contacts on the remote control and the battery before installation. Always check the correct polarity when inserting the battery and remove used batteries promptly. If there are no local regulations against it, they can be disposed of in common waste bins..

2. FEATURES

- 1. High-quality plastic casing with a long service life.
- 2. PTC ceramic heating elements, high-efficiency high efficiency, fast heating, fast, silent, odourless, non-polluting, no flames and does not reduce oxygen levels.
- 3. Two heat settings, you can adjust the temperature to your liking.
- 4. Equipped with a temperature fuse to prevent overheating and protect against motor overheating. Automatically shuts off when the air outlet is blocked and turns back on when cleared.
- 5. Natural/hot air selection. The heating element can be turned off in summer; the heater can blow cool air.
- 6. Safety thermostat. Protection against overheating.

Technical parameters:

Model	Nominal power	Nominal voltage	Nominal frequency	Class II
PTC2020C	2000W	220-240V~	50/60 Hz	

3. INSTALLATION

Drill two holes in the wall and leave a distance of 2.0 m from the floor. The diameter of the hole must be large enough to accommodate the expansion bolt (6 mm). After inserting the expansion bolt, secure the hook to the bolt with a screw. Ensure that the hook is inserted into the lower part. Use the machine components (screws and expansion tube) to secure it to the wall as shown in the figure below, then mount the machine. THE WALL MUST BE ABLE TO SUPPORT AT LEAST 4.1 KG OF WEIGHT.

The distance between the product and the ceiling and the side must be 30 cm. When installing the product, the hook must be aligned with hole "A" and then aligned with hole "B". When removing the product, it must be moved from hole "B" to "A" and then removed.

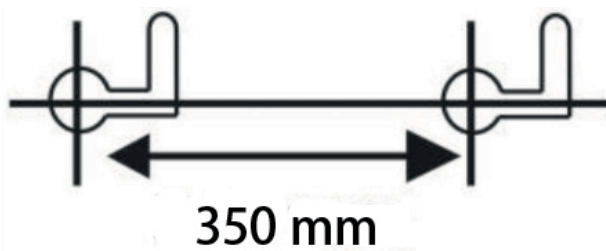
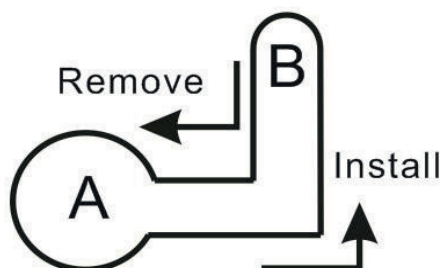
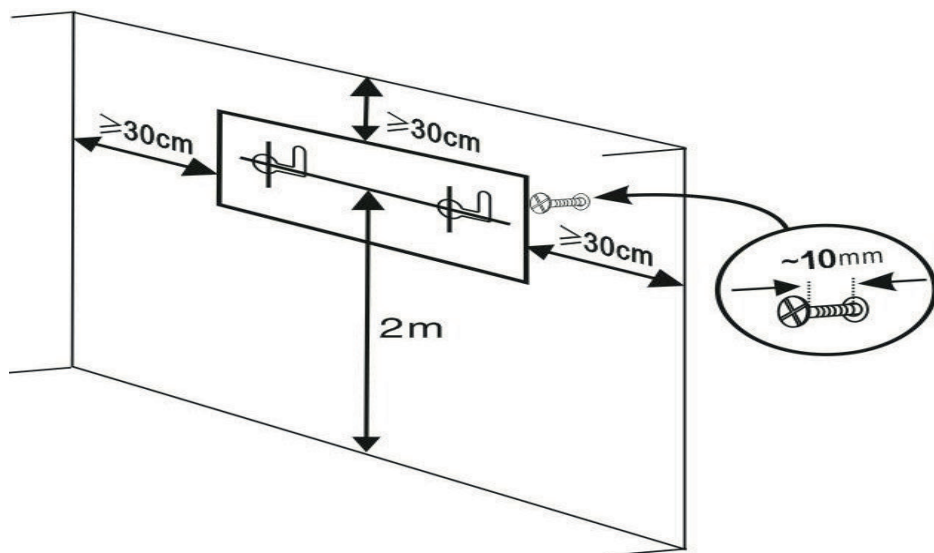

4. USE

1. Please ensure that the capacity is 220-240V~, 50-60Hz.
2. Plug the plug into the power socket.
3. Switch on the appliance by selecting the desired setting.

"0" is "OFF". "-" is "ON".
4. Please operate the machine using the control buttons on the control panel or the remote control.



5. DISPLAY

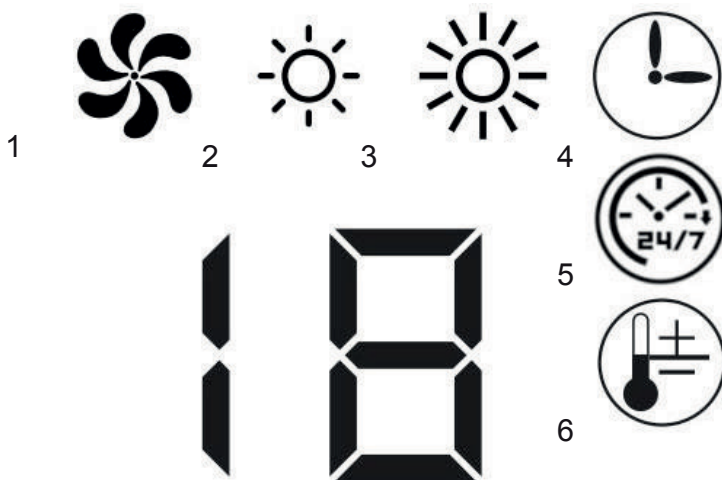

1. Ventilation mode. 2,100W

3,2000W

4. Timer

5. Weekly timer

6. Temperature adjustment: if it is on, adjust the temperature. If the light flashes, Open Window Detection Mode is starting.

6.

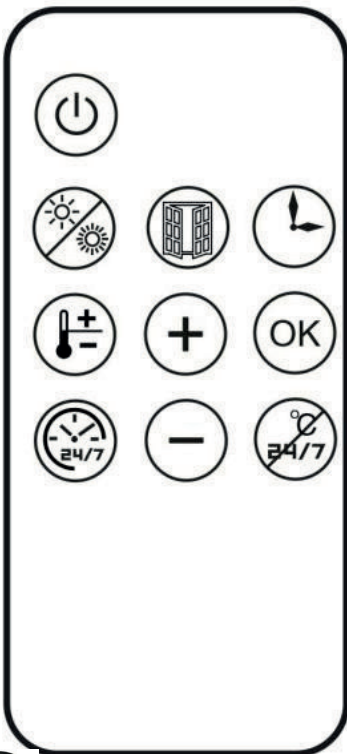

ON/OFF



1000/2000W,
Ventilation.



Timer from 1 to
8 hours; this function cannot be
used when the timer is started
is started.



Press "+" "-" to adjust the
temperature. Temperature
range: 18-45°.



Open window detection mode can only be activated when the appliance is in heating mode, not when it is in ventilation mode or when the timer is programmed. Press this button to activate or deactivate this mode.

Once this option has been pressed, open window detection will begin one minute after the button has been pressed and every 10 minutes the open window will be detected in two 5-minute intervals.

If during these 10 minutes the temperature
drops $\leq 8^{\circ}$, the appliance continues to heat and the

Open window protection continues to function. If the temperature changes by more than 8° during the detection process, the appliance stops heating and goes into standby mode, and the open window detection stops. OBSERVATIONS: When the appliance stops heating, the alarm continues to sound for 5 seconds and the fan continues to operate for 30 seconds, then goes into standby mode, and the set temperature mode light and display flash.



Press this button to activate the weekly timer.



Cancelling the temperature setting: if you have set the temperature and wish to change it again, press '  ' and then this button.

Cancelling the weekly timer: if you have set the temperature and wish to change it again, press  and then this button.



7. OPEN WINDOW SYSTEM

Open window detection mode can only be activated when the appliance is in heating mode.

,not when ventilation is in use or the timer is programmed. Press this button to activate or deactivate this mode.

Once this option has been pressed, open window detection will begin one minute after the button has been pressed and every 10 minutes the open window will be detected in two 5-minute intervals.

If during these 10 minutes the temperature drops $\leq 8^{\circ}$, the appliance continues to heat and the open window detection continues to function. If the temperature changes $> 8^{\circ}$ during the detection process, the appliance stops heating and goes into standby mode, and the open window detection stops.

OBSERVATIONS: When the appliance stops heating, the alarm sounds for 5 seconds and the fan continues to operate for 30 seconds, then goes into standby mode, the set temperature mode light and the display flash.

If an open window is detected, the appliance switches off. Press the Open Window Detection Mode button again to restart this mode. Press ON/OFF to stop the appliance and standby mode.

8. R WEEKLY TIMER

Weekly timer mode: The weekly timer can only be activated when the appliance is in heating mode (it cannot be activated when the appliance is in fan mode only) or in programmed temperature mode.

The first time it is started up (after a power cut), the display time must be set.

A. Set the day of the week: LED display 01 (01 is Monday, 02 is Tuesday, etc.) press + or - to set the current day, 01-07 is Monday to Sunday. Press OK to complete the setting.

B. Set the hours: LED display 00 is 0H. Press + or - to set the current time, 00 to 23, is 0H to 23H. Press OK to complete the setting.

C. Set the minutes: LED display 00, is 0min press + or - to set the current minutes, 00 to 59, is 0min to 59min. Press OK to complete the setting.

Note:

If OK is not pressed within 10 seconds of the setting, the current time setting will fail. Therefore, you must first cut the power and then reset the current time. Once this key has been pressed, set the day with the desired operating hour interval. The setting method from 20 to 07 is the same as for 01.

1. Only one working time cycle (from start to stop) can be set per day.
2. Only hours can be set, not minutes.
3. In preset mode, you must set the start and stop times. If there is a power cut, the weekly timer memory function will be erased, but if there is no power cut, the appliance has a memory function.

To turn off the weekly timer, press this button 7 times .

After adjustment, the LED display may show the weekly timer indicator light on and the corresponding selected function as well. The oscillation, low heat, high heat, temperature adjustment and open window detection functions can be used in weekly timer mode or in normal operating mode. The indicator light comes on when the corresponding function is operating.

The maximum detection temperature is 51°, when

When the appliance reaches this temperature, it will switch off.

6. CLEANING AND MAINTENANCE

- Always disconnect the power supply before cleaning the heater. First, disconnect the main power supply. Then, unplug the cable from the power outlet.
- Do not use this heater if any of its parts have come into contact with water. Contact technical support and replace any electrical parts that have been submerged in water.
- The heater motors are pre-lubricated for long-lasting use and do not require further lubrication or maintenance. To remove any dust or dirt build-up, occasionally use a soft brush or vacuum cleaner to clean the grilles.
- To remove dust, use a soft, clean, damp cloth that will not scratch the surface. Do not use household cleaners or abrasives, as these products can damage the surface.
- When cleaning the glass display screen, use a damp, non-abrasive cloth with liquid cleaner or mild soap if necessary, as abrasive substances will scratch the screen.
- Under no circumstances should this product be used with a broken screen. Do not knock it.
- If your appliance becomes stained or damaged in any way during use, we recommend that you contact technical support.

8. RECYCLING OF HOUSEHOLD APPLIANCES



European Directive 2012/19/EU on Waste Electrical and Electronic Equipment (WEEE) specifies that electrical appliances must not be recycled with other municipal waste.

These appliances must be disposed of separately in order to optimise the recovery and recycling of materials and thus reduce the impact they may have on human health and the environment.

The crossed-out wheeled bin symbol reminds you of your obligation to dispose of this product correctly. To dispose of your electrical appliances and/or the corresponding batteries, consumers must take them to a recycling centre.

9. WARRANTY

To PROCESS the warranty for any of our products, you must send an email to sat@avanzzatraders.com, attaching the following:

- A photograph of the purchase receipt.
- Photographs of the condition and fault of the product.
- Photograph of the product packaged for collection (if you have contracted this service).
- Warranty activation form (at the end of the document) with all boxes filled in.

This product has a 3-year warranty from the date of purchase. Please keep the purchase invoice and packaging in a safe place (keep the packaging for at least 15 days).

The warranty will cover all manufacturing defects for 3 years in accordance with current legislation. Provided that the product is in perfect condition and in its original packaging, and has been used properly as indicated in the instruction manual. In case of misuse, the manufacturer will not be responsible for repairs.

The warranty shall NOT apply:

-If the product has been used beyond its capacity or usefulness, mistreated, knocked, exposed to moisture, submerged in any liquid or corrosive substance, as well as any other fault attributable to the consumer, such as misuse due to failure to follow instructions, improper transport or use of electronic components or accessories that are not suitable, as indicated in the manual.

If the product has been disassembled, modified or repaired by persons not authorised by the Technical Service. If the product has been stolen or the damage has been caused by accident or by an external element or natural disaster.

-If the incident has been caused by normal wear and tear of parts due to use, or has been a breakdown caused by physical damage, such as breakage of plastics, enamels or similar. If the product is started up and the user is shown that it works. If the product does not have the identification label or has been modified (model or serial number).

All products are repaired by the Technical Service in Spain and Portugal. If the product was not purchased in these two countries, the warranty covers the repair costs but not the transport costs to the Technical Service or back to the customer.

The warranty does not cover any costs arising from the installation or uninstallation of the product. If the item is covered by the warranty, Avanzza Traders S.L. will cover all costs, transport and repair. If the item is not covered by the warranty, you will be provided with a quote for your approval. If you accept, all repair, shipping and collection costs will be at your expense, including the box in which it will be returned to you, if it did not come in suitable packaging.

If the product was not purchased through an official distributor of Avanzza Traders International S.L. and you detect an issue with the product or have any questions, please contact the Technical Support Service of Avanzza Traders International S.L. by email at sat@avanzzatraders.com.

Yours sincerely, the Avanzza Traders International S.L team

CENTRO/CLIENTE	
PERSONA DE CONTACTO	
FECHA DE COMPRA	
FECHA DE INCIDENCIA	
DIRECCIÓN DE RECOGIDA	
CÓDIGO POSTAL:	
TELÉFONO:	
MAIL:	
PRODUCTO Y N° SERIE:	
BREVE DESCRIPCIÓN DEL PROBLEMA	



10.ADDITIONAL INFORMATION ABOUT

Table	Model identifier for local electric heaters			
No.	309020222-PTC-2020			
Item		Symbol	Value	Unit
Heat output				
Nominal heat output nominal		P _{nom}	2,000	kW
Heat output minimum (indicative)		P _{max}	1,000	kW
Maximum continuous heat output		P _{max, c}	2,000	kW
Auxiliary electrical consumption				
In off mode		P ₀	0.00	W
In standby mode		P _{sm}	0.62	W
In inactive mode		P _{idle}	N/A	W
In network standby mode		P _{nsn}	N/A	W
Heating capacity/temperature control type Ambient (single selection)				
Single stage without ambient temperature control				No
Two or more stages without ambient temperature control				No

With thermostatic control of the ambient temperature	No
With electronic ambient temperature control	No
With electronic ambient temperature control and daily timer	No
With electronic room temperature control and weekly timer	Yes

Seasonal energy efficiency for space heating in inactive mode	$\eta_{S,on}$	92.0	%
---	---------------	------	---

Other control options (multiple selection)	
Room temperature control with presence detection	No
Room temperature control, with open window detection	Yes
With distance control option	No
With adaptive start control	No
With working time limitation	Yes
With black bulb sensor	No
With self-learning functionality	No
With precise control	No
Contact details: sat@avanzzatraders.com	